



GRAVITYFLOW[®]

Belt Drive System

The Gravity Flow Belt Drive Door System delivers reliable and smooth performance that's easy to use and operate. The system utilizes dual sets of hi-strength belts that mechanically move the door open and closed.

Notable differences compared to other competitors

- 1" Cross Shaft Diameter
- .125" Tub Panel Thickness (hopper stiffener not required)
- 1" U-Joint
- 5000 lb. Belt Rating (Linear Breaking Strength)
- 4" Overlap on Tub Panel & Trap Frame Attachment
- Full Contact Trap Seal During Door Travel

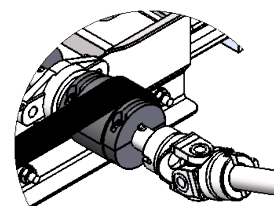
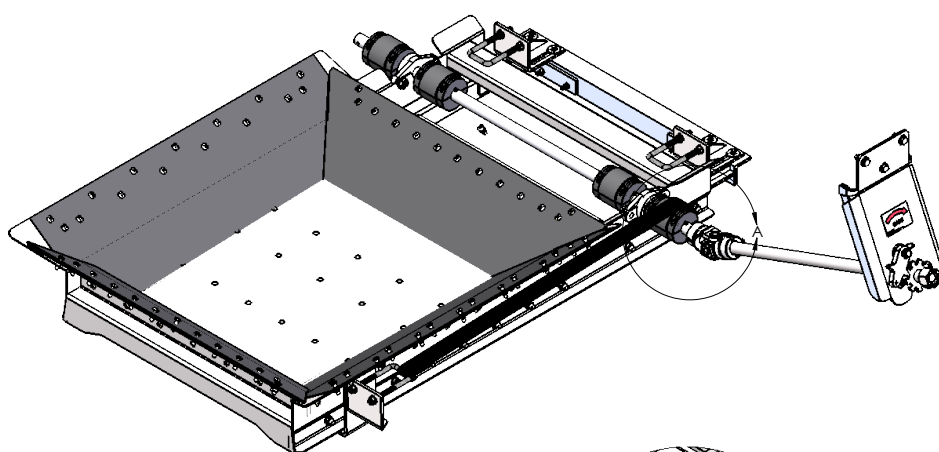

DETAIL A
SCALE 1 : 4



Since 1884

For more information contact your local TimpTE Factory Direct Customer Support Center or Authorized Dealer Location

TIMPTE.COM

MADE IN AMERICA

Gravity Flow Belt Drive System Options

AG TUB			
LENGTH	WIDTH	OPTION	OPENING SIZE
36'	96W	03324-366/	29-1/2"L x 26-5/8"W
36'	102W	03324-362/	29-1/2"L x 32-5/8"W
38'	96W	03324-386/	29-1/2"L x 26-5/8"W
40'	96W	03324-406/	29-1/2"L x 26-5/8"W
40'	102W	03324-402/	29-1/2"L x 32-5/8"W
42' 2"	96W	03324-426/	29-1/2"L x 26-5/8"W
42' 2"	102W	03324-422/	29-1/2"L x 32-5/8"W
48'	96W	03326-486/	40-7/8"L x 26-5/8"W
50'	96W	03326-506/	40-7/8"L x 26-5/8"W

SPLIT TUB			
LENGTH	WIDTH	OPTION	OPENING SIZE
40'	96W	03325-406/	40-7/8"L x 29-1/8"W
40'	102W	03325-402/	40-7/8"L x 35-1/8"W
42' 2"	96W	03325-426/	40-7/8"L x 29-1/8"W
42' 2"	102W	03325-422/	40-7/8"L x 35-1/8"W

HI-FLOW			
LENGTH	WIDTH	OPTION	OPENING SIZE
40'	96W	03329-406/	40-7/8"L x 35-1/8"W
42' 2"	96W	03329-426/	40-7/8"L x 35-1/8"W

SHORTER DOOR ON 43' PLUS SPLIT TUB			
LENGTH	WIDTH	OPTION	OPENING SIZE
50'	102W	03327-502/	40-7/8"L x 35-1/8"W

LARGER DOOR AG TUB			
LENGTH	WIDTH	OPTION	OPENING SIZE
40'	96W	03328-406/	40-7/8"L x 26-5/8"W



Since 1884

For more information contact your local TimpTe Factory Direct Customer Support Center or Authorized Dealer Location

TIMPTE.COM

MADE IN AMERICA