



TIMPTE ***SUPER HOPPER***

MADE IN AMERICA 

Nobody pulls their weight like we do.

About Us

Timpte® has been manufacturing bulk commodity trailers for over 135 years. As one of the pioneers in the development of these trailers, we have positioned ourselves to serve your needs today and in the future.

Timpte trailers are designed for those who require the best. We design strength and performance into each new Timpte, but that's only part of our story. Timpte's insistence on using only the finest materials is further assurance of unsurpassed value. We use only the highest quality aluminum and steel in our construction.

The engineering and design leadership that goes into each Timpte trailer shows in our distinctive good looks, craftsmanship, structural detail and the methods by which Timpte trailers are produced. Value comes from Timpte's tradition of quality.

We are recognized throughout the bulk commodity transportation industry as the leader in quality. To understand what trailer value is all about, take a look at a new Timpte. There's a reason we are the #1 manufacturer of bulk commodity trailers in the country.



Design

Our diversified engineering team develops, designs and tests each new product from start to finish. They have the ability to handle any request to get you the trailer you want.

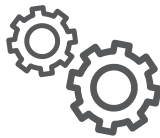

Manufacture

We custom build every trailer in one manufacturing facility which provides you with consistent product quality that's built on time.



Sell

We give you expert advice on how to increase your operation's productivity and the confidence that you're getting the right trailer that fits your needs.



Service

With more than 40 locations in the United States & Canada, Timpte's extensive network means you're never too far from Timpte genuine parts and service.



Standard Features

1. **Electric Tarp System:**

THUNDER 6000^{XR}

Standard with the Thunder 6000^{XR} Series Electric Tarp. This dual arm tarping system includes One-Touch™ technology, 100% American made motor and multi-function remote.

See page 13 for more information.

2. **Side Panels:**

.063" aluminum panels are used in high stress areas for added strength and durability.

(2) .063" panels on 38' - 43'

(3) .063" panels on 48' - 50'

- 4' Exterior Side Panels: A long time Timppte trademark that offers unmatched strength and ease of repair.

3. **Air Ride Dump Valve**

& Oil Filled Pressure Gauge:

Relocated to the nose of the trailer where it is immediately accessible to the operator on all trailers.

**Does not apply to tri-axle trailers with lift axle(s).*

4. **Lights & Electrical:**

All weather-pack automotive style connections, sealed to prevent corrosion. Standard light configuration:

- 2 rows of 3 LED bullet lights with center mid-ship turn signal.
- (2) Front high-mount LED bullet lights
- (5) Rear high-mount marker LED bullet lights
- (6) 4" diameter stop/turn signal LED bullet lights

5. **Upper Coupler Assembly:**

The upper coupler assembly is a beam truss designed for the rigors of field use. Extra crossmembers and a "X" brace are added for extra strength for field application.



***The trailer shown above is used for DEMONSTRATION purposes only.**

All referenced points are standard features on all Timppte models.

Optional upgrades on this trailer include: stainless steel corners, stainless steel rear and outside level 1 aluminum wheels, polished aluminum electric tarp system

Timppte reserves the right to change design or specifications without notice. Information contained herein is general in nature and is not intended for specific applications purposes.

Timpte's value comes from our tradition of quality.

More standard features from front to back than any other trailer manufacturer.



6. Trap System:

Timpte traps are made of 1/4" aluminum plate with hat section stiffeners to minimize deflection. Each door rides on sealed HD 40 mm diameter roller bearings designed to give years of trouble free service. Note the interior trap door seal protects against moisture intrusion.

7. Tarp:



Made of 18 oz. premium-grade woven PVC. The tarp construction is all heat-welded which adds strength and thickness to high stress areas.

8. Access System:

Standard with front and rear aluminum ladders and 26" rear grab bar.

- Standard Flip Step Ladder: The Timpte Original! A functional ladder extension that stores in the upward position and is swung down to provide unequalled rear access and safety.

9. Rear Corner Frame Posts:

Gives all models the ability to vent through the corner posts.

10. Tarp Bows:

Heavy duty extruded aluminum box design top rail eliminates having to use fixed structural tarp bows. Timpte tarp bows are easily replaced if damaged. 2 ridge straps are standard.



Timpte offers an industry leading 3 year "Peace of Mind No Hassle Warranty" on all new trailers.

See Timpte Warranty Card for details.

Super Hopper Models

Standard Hoppers

Lengths - 21'-11", 28'-6", 33'-5", 36', 38', 40' and 42'-2"
Widths - 96" and 102" (22'-11" - Only available in 96" wide)



Spread-Axle Models

Lengths - 48' and 50'
Widths - 96" and 102"



SL Standard Models

Lengths - 40' and 42'-2"
Width - 96"



Lead & Pup

Lengths - Lead 28'-6" 33'-5", 36', 38', 40', 42'-2", 43', 48' and 50'
Pup 25'-6", 21'-11" and 18'
Widths - 96" and 102"



Super Cube

Lengths - 43' Only
Width - 96" and 102"



Tri-Axle Models

Lengths - 48' and 50'
Widths - 96" and 102"



SL Tri-Axle Models

Length - 50'
Width - 96"



Tri-Axle Doubles

Lengths - Lead 36'-10"
Pup 36'-10"
Widths - 102"



Tub Configurations

Tub Styles



Ag Hopper - 25" Ground Clearance



Hi-Flow - 20.5" Ground Clearance



Split Tub - 17" Ground Clearance

Tub Options



Removable Vibrators

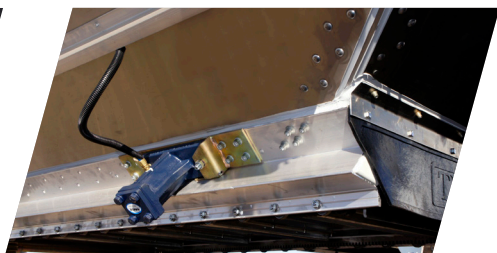

Permanent Vibrators



Full Double Knock Rails



Sight Glass Window

Door Options

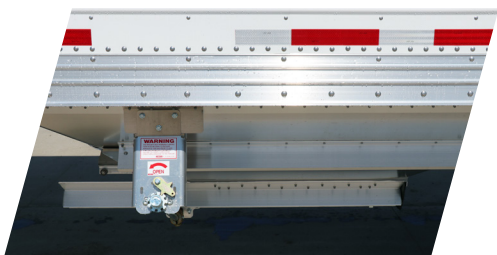

Single Speed Operator
(Direct Drive)



Two-Speed Operator
(Gear Drive)



Gravity Flow - **NEW**
(Belt Drive)



EZ Flow^{XR}®
(Hydraulic Drive)

Popular Options

Front Options



Front Splash Guards



Landing Gear Mud Flaps



K-Bracing



Double Split Platforms



Front Aluminum Enclosure

Rear Options



Rear Doors



Full Width Aluminum Step



P89 Air Disc Brake System



Custom Suspension Paint



Rear Aluminum Enclosure

Tarp Options

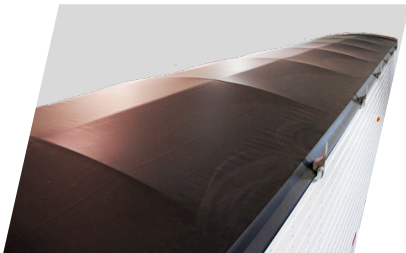

22 oz. Tarp



Custom Tarp Colors

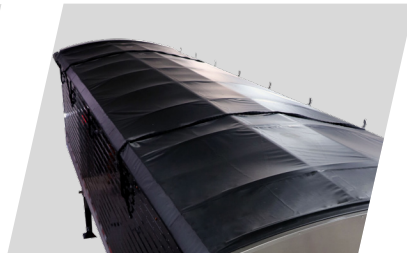

Clean Coat Acrylic Tarp



Thunder Tarp Straps

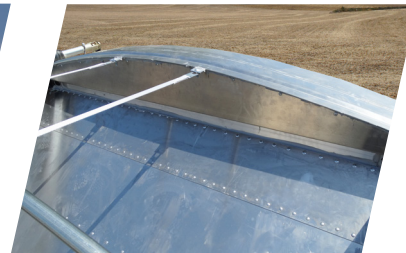

Enclosed Tarp Caps

Panel Options & Sidewall Heights

Stainless Steel Options



Stainless Steel Nose



Stainless Steel Rear



Stainless Steel Corners

Sidewall Heights

Sidewall Heights available:

66"	90"
72"	96"
78"	102"
84"	



102" Sidewall Height Shown

Sidewall Panel Options

Other Colors Available Upon Request



Silver



Stainless Steel



Black



White

Light Options

Side Marker Lights



Bullet Lights (Standard)



Clear Bullet Lights (Optional)



Marker Lights



Box Style Lights (Optional)



Clear Box Style Lights (Optional)



Marker Lights

Available Side Marker LED Light Configurations:

1 row of 3/5/9/13/15/17

2 rows of 3 (Standard)

2 rows of 5/9/13/15/17

3 rows of 3/5/9/13/15/17

* Extra Spacing; Available on any 2 row configuration

* Configuration options vary depending on length of trailer

Tail Lights



Standard Lights



Clear Lights (Optional)



Rear Backup Light (Optional)

Work Lights

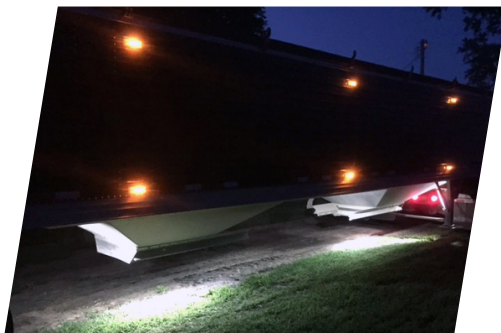

Apex

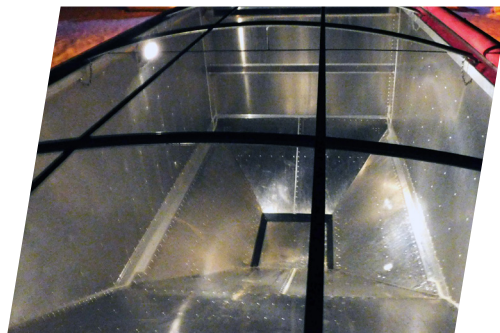

Interior Tubs

Rear Light Options



3 LED Light Cluster on Lower Bumper Rail



7 LED Lights on Rear Header
4 Outside Lights Turn/Clearance
3 Inside Lights Stop/Clearance



Rear Corner Post Lights

PETERSON
MANUFACTURING CO.



WIRING HARNESS



LIGHTS



2 rows of 15 with extra spacing shown

Lightweight Options

Tandem Axle Aluminum Subframe

- Available with front lift axle
- Increased wall thickness of long beams by 25%



Tri-Axle Aluminum Subframe

- Available for 48' and 50' tri-axles with both spread and closed spaced tandem
- Available with front and rear lift axles

Ask your factory direct or dealer representative regarding lift and spread axle configuration availability.



Weight Saving Options

Fig. Super Light Option	96" Wide	102" Wide
A. Aluminum Upper Coupler	435 lbs.	470 lbs.
B. (4) Aluminum Wheels / 22.5 Wide Base Tires	633 lbs.	633 lbs.
C. Aluminum Subframe w/ TP Axles	364 lbs.	364 lbs.
D. Lightweight Hubs (Std) & Drums	92 lbs.	92 lbs.



Fig. A



Fig. B



Fig. C



Fig. D



Aluminum Wheel Options

Wheel Size	Finish
24.5 x 8.25	Ultra ONE® / Dura-Brite®
22.5 x 8.25	Ultra ONE® / Dura-Brite®
22.5 x 14	Ultra ONE® / Dura-Brite®

Thunder 6000^{XR}

Technology Behind the Product

- One-Touch™ Technology allows the operator to open and close the tarp system with one push of a button
- One-Touch™ Technology works by measuring amperage load to a preset value
- Open, close and stop your tarp with one push of a button
- Simple 3-button remote design is easy to operate, with large easy-to-read buttons
- Multi-function remote can operate up to 5 different trailer accessories with a maximum range of 100 ft.
- Safety features include automatic remote shut-off after 5 minutes of inactivity



Amp Relay & Plug and Play Wiring Harness
Amp relay provides outstanding performance & displays easy-to-read diagnostic blink codes to keypad. Junction box is sealed and mounted on the backside of the nose panel and utilizes plug and play connections.

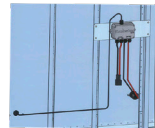

HD Arms & Brackets
1st HD system on the market with modular HD polished aluminum arms

XR Series Motor

The XR Series Motor has a rock solid design with industrial strength motor case. This motor has 4 times the performance & reliability and utilizes precision worm gear braking.
100% American Made Motor

Easy Motor Disconnect

Single pin can be disengaged in minutes for manual operation

Hinge Joint

Provides constant tarp tension during windy days and is adjustable for various load conditions

Rear Arm Ball & Socket

Ball & socket handles the stress of the flexure of the roll pipe for a smoother roll - Patent Pending -

One-Touch™ Technology

Allows the operator to open and close the tarp system with one push of a button

Watertight Keypad

Low profile, easy to use, epoxy potted for a completely watertight keypad

Optional upgrades on this trailer include; polished aluminum electric tarp system



Arm Color Options

*Image shows custom white finish



Standard Mill Finish - 01



Polished Aluminum - 02

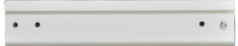

White - 04



Black - 03



Hammered Gray - 05



Best In Industry
WARRANTY



PARTS



MOTOR

EZ Flow^{XR} Hydraulic Trap[®]

TESTED TO MEET YOUR TOUGH HAULING DEMANDS.

The patented EZ Flow^{XR} Hydraulic Trap[®] has been thoroughly tested to meet your tough hauling demands for the last nine years. From field to road there is no hydraulic or electric trap that compares to strength and reliability of the EZ Flow^{XR}.

Features

- Industries BEST Swing Clearance; No trap operator or motor to interfere with swing auger
- Operates using a single 12 volt hydraulic motor
- No Limit Switches
- Easily control product flow by feathering the door open or close
- Standard door opens in 12 seconds & closes in 10 seconds
- Standard with heavy duty reinforcement brackets for hi-density products (silica sand)
- Door opens past the rear trap frame cross-member by 1" (Full Open Door)

EZ Flow^{XR} Hydraulic Trap[®] Override



In the event of an emergency due to electrical or mechanical failures the EZ Flow^{XR} doors can be easily converted into manual operation. The emergency manual override utilizes quick release pins and straps to open the door. This new override system is not only easy to use, but provides additional ground clearance compared to previous override systems.

EZFLOW^{XR}
Hydraulic Trap[®]



Capacities

LENGTH & HEIGHT	HEAPED 9"				WATER LEVEL			
	96" Wide		102" Wide		96" Wide		102" Wide	
	Ag	Split	Ag	Split	Ag	Split	Ag	Split
18' 0" Length, 72" Height	765 ft ³	---	---	---	688 ft ³	---	---	---
18' 0" Length, 78" Height	830 ft ³	---	---	---	753 ft ³	---	---	---
21' 11" Length, 66" Height	828 ft ³	---	---	---	734 ft ³	---	---	---
21' 11" Length, 72" Height	908 ft ³	---	---	---	814 ft ³	---	---	---
21' 11" Length, 78" Height	988 ft ³	---	---	---	894 ft ³	---	---	---
21' 11" Length, 84" Height	1068 ft ³	---	---	---	974 ft ³	---	---	---
25' 6" Length, 78" Height	---	---	1131 ft ³	---	---	---	1013 ft ³	---
28' 6" Length, 66" Height	1037 ft ³	---	1108 ft ³	---	913 ft ³	---	976 ft ³	---
28' 6" Length, 72" Height	1143 ft ³	---	1221 ft ³	---	1019 ft ³	---	1089 ft ³	---
28' 6" Length, 78" Height	1249 ft ³	---	1334 ft ³	---	1125 ft ³	---	1202 ft ³	---
33' 5" Length, 66" Height	1247 ft ³	---	1332 ft ³	---	1101 ft ³	---	1176 ft ³	---
33' 5" Length, 72" Height	1369 ft ³	---	1462 ft ³	---	1223 ft ³	---	1307 ft ³	---
33' 5" Length, 78" Height	1493 ft ³	---	1595 ft ³	---	1347 ft ³	---	1439 ft ³	---
36' 0" Length, 66" Height	1327 ft ³	---	1420 ft ³	---	1172 ft ³	---	1254 ft ³	---
36' 0" Length, 72" Height	1459 ft ³	---	1562 ft ³	---	1304 ft ³	---	1396 ft ³	---
36' 0" Length, 78" Height	1591 ft ³	---	1702 ft ³	---	1436 ft ³	---	1534 ft ³	---
36' 10" Length, 78" Height	---	---	1651 ft ³	---	---	---	1484 ft ³	---
38' 0" Length, 66" Height	1409 ft ³	1473 ft ³	1505 ft ³	---	1245 ft ³	1309 ft ³	1330 ft ³	---
38' 0" Length, 72" Height	1536 ft ³	1603 ft ³	1640 ft ³	1709 ft ³	1357 ft ³	1421 ft ³	1450 ft ³	1519 ft ³
38' 0" Length, 78" Height	1674 ft ³	1738 ft ³	1788 ft ³	1857 ft ³	1479 ft ³	1543 ft ³	1581 ft ³	1650 ft ³
40' 0" Length, 66" Height	1439 ft ³	1561 ft ³	1561 ft ³	1692 ft ³	1293 ft ³	1415 ft ³	1408 ft ³	1539 ft ³
40' 0" Length, 66" Height SL	1439 ft ³	1561 ft ³	---	---	1293 ft ³	1415 ft ³	---	---
40' 0" Length, 72" Height	1587 ft ³	1709 ft ³	1703 ft ³	1834 ft ³	1441 ft ³	1563 ft ³	1547 ft ³	1678 ft ³
40' 0" Length, 72" Height SL	1587 ft ³	1709 ft ³	---	---	1441 ft ³	1563 ft ³	---	---
40' 0" Length, 78" Height	1735 ft ³	1857 ft ³	1861 ft ³	1992 ft ³	1589 ft ³	1711 ft ³	1705 ft ³	1836 ft ³

BULK COMMODITY

PRODUCTS	LBS. PER	LBS. PER
	CUBIC FT	BUSHEL
alfalfa meal	17	21
alfalfa seed	48	60
barley,whole	38	47
beans	50	62
bran	16	20
brewer's grain, dry	42	52
corn,cracked	45-50	56-62
corn,shelled	45	56
cottonseed	26	32
cornmeal	38-40	47-50
cottonseed meal	35-40	44-50
dirt,common dry	70-80	-
fertilizer	60	-
flaxseed	45	56
flaxseed meal	25	31

Cubic Feet (ft³) ÷ 1.244 = Bushel

PRODUCT CHART

PRODUCTS	LBS. PER CUBIC FT	LBS. PER BUSHEL
gravel, dry	90-100	-
limestone, loose	100	-
limestone, pulverized	85-90	-
oats	26	32
oats, crushed	22	27
molasses feed	40	50
potash	80	-
rice, hulled	45-48	56-60
sand, dry	90-110	-
soybeans, whole	45-50	56-62
soybean meal	40	50
soybeans, cracked	32-36	40-45
sunflower seed	19-26	24-32
wheat, cracked	40-45	50-56
wheat	45-48	56-60

Capacity of Corn, Shelled

LENGTH & HEIGHT	HEAPED 9"				WATER LEVEL			
	96" Wide		102" Wide		96" Wide		102" Wide	
	Ag	Split	Ag	Split	Ag	Split	Ag	Split
40' 0" Length, 84" Height	1886 ft ³	2008 ft ³	2019 ft ³	2150 ft ³	1735 ft ³	1857 ft ³	1863 ft ³	1994 ft ³
42' 2" Length, 66" Height	1468 ft ³	1602 ft ³	1576 ft ³	1720 ft ³	1319 ft ³	1453 ft ³	1417 ft ³	1561 ft ³
42' 2" Length, 66" Height SL	1,468 ft ³	1,602 ft ³	---	---	1,319 ft ³	1,453 ft ³	---	---
42' 2" Length, 72" Height	1,619 ft ³	1,753 ft ³	1,738 ft ³	1,882 ft ³	1,467 ft ³	1,601 ft ³	1,576 ft ³	1,720 ft ³
42' 2" Length, 72" Height SL	1,619 ft ³	1,753 ft ³	---	---	1,467 ft ³	1,601 ft ³	---	---
42' 2" Length, 78" Height	1,776 ft ³	1,910 ft ³	1,904 ft ³	2,048 ft ³	1,622 ft ³	1,756 ft ³	1,739 ft ³	1,883 ft ³
42' 2" Length, 84" Height	1,932 ft ³	2,066 ft ³	2,070 ft ³	2,214 ft ³	1,778 ft ³	1,912 ft ³	1,905 ft ³	2,049 ft ³
42' 2" Length, 90" Height	2,087 ft ³	2,221 ft ³	2,235 ft ³	2,379 ft ³	1,933 ft ³	2,067 ft ³	2,070 ft ³	2,214 ft ³
43' 0" Length, 72" Height	1,742 ft ³	1,887 ft ³	1,867 ft ³	2,025 ft ³	1,586 ft ³	1,731 ft ³	1,700 ft ³	1,858 ft ³
43' 0" Length, 78" Height	1,908 ft ³	2,053 ft ³	2,043 ft ³	2,201 ft ³	1,752 ft ³	1,897 ft ³	1,876 ft ³	2,034 ft ³
43' 0" Length, 84" Height	2,075 ft ³	2,220 ft ³	2,221 ft ³	2,379 ft ³	1,919 ft ³	2,064 ft ³	2,054 ft ³	2,212 ft ³
43' 0" Length, 90" Height	2,242 ft ³	2,387 ft ³	2,399 ft ³	2,557 ft ³	2,086 ft ³	2,231 ft ³	2,232 ft ³	2,390 ft ³
43' 0" Length, 96" Height	2,409 ft ³	2,554 ft ³	2,577 ft ³	2,735 ft ³	2,253 ft ³	2,398 ft ³	2,410 ft ³	2,568 ft ³
43' 0" Length, 102" Height	2,576 ft ³	2,721 ft ³	2,755 ft ³	2,913 ft ³	2,420 ft ³	2,565 ft ³	2,588 ft ³	2,746 ft ³
48' 0" Length, 66" Height	1,581 ft ³	1,726 ft ³	---	---	1,425 ft ³	1,570 ft ³	---	---
48' 0" Length, 72" Height	1,752 ft ³	1,897 ft ³	---	---	1,592 ft ³	1,737 ft ³	---	---
48' 0" Length, 78" Height	1,923 ft ³	2,068 ft ³	2,059 ft ³	2,217 ft ³	1,760 ft ³	1,905 ft ³	1,884 ft ³	2,042 ft ³
48' 0" Length, 84" Height	---	---	2,242 ft ³	2,400 ft ³	---	---	2,064 ft ³	2,222 ft ³
48' 0" Length, 90" Height	---	---	2,425 ft ³	2,583 ft ³	---	---	2,244 ft ³	2,402 ft ³
50' 0" Length, 66" Height	1,581 ft ³	1,726 ft ³	---	---	1,424 ft ³	1,569 ft ³	---	---
50' 0" Length, 72" Height	1,753 ft ³	1,898 ft ³	1,879 ft ³	2,037 ft ³	1,591 ft ³	1,736 ft ³	1,706 ft ³	1,864 ft ³
50' 0" Length, 72" Height SL	1,785 ft ³	1,930 ft ³	---	---	1,594 ft ³	1,739 ft ³	---	---
50' 0" Length, 78" Height	1,929 ft ³	2,074 ft ³	2,065 ft ³	2,223 ft ³	1,762 ft ³	1,907 ft ³	1,886 ft ³	2,044 ft ³
50' 0" Length, 84" Height	2,103 ft ³	2,248 ft ³	2,250 ft ³	2,408 ft ³	1,933 ft ³	2,078 ft ³	2,068 ft ³	2,226 ft ³
50' 0" Length, 90" Height	---	---	2,434 ft ³	2,592 ft ³	---	---	2,249 ft ³	2,407 ft ³

Diagrams

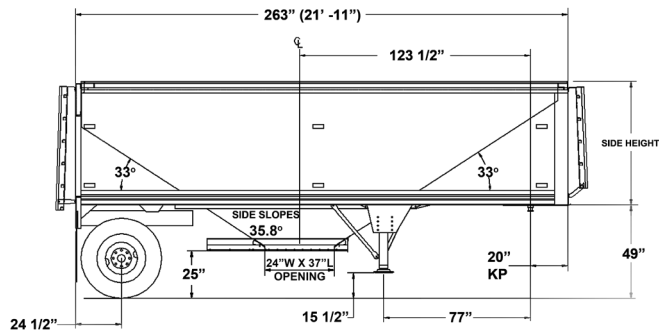

21' 11" SUPER HOPPER

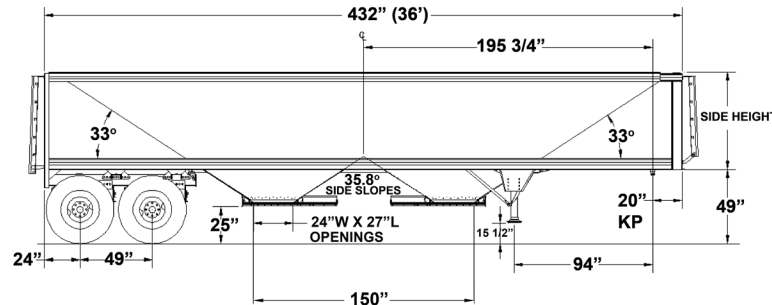

36' SUPER HOPPER

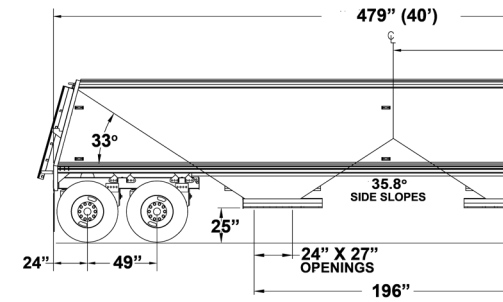

40' SUPER HOPPER SL

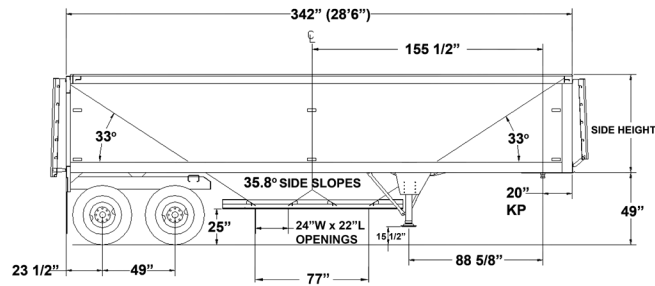

28' 6" SUPER HOPPER

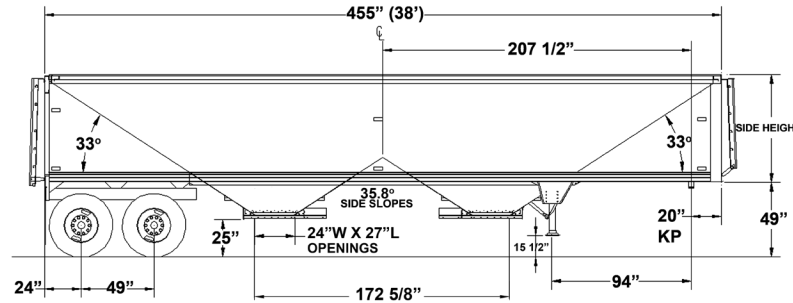

38' SUPER HOPPER

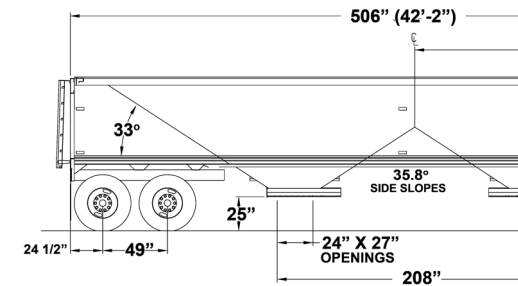

42' 2" SUPER HOPPER

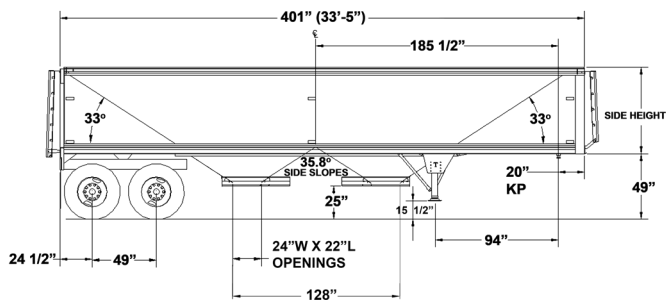

33' 5" SUPER HOPPER

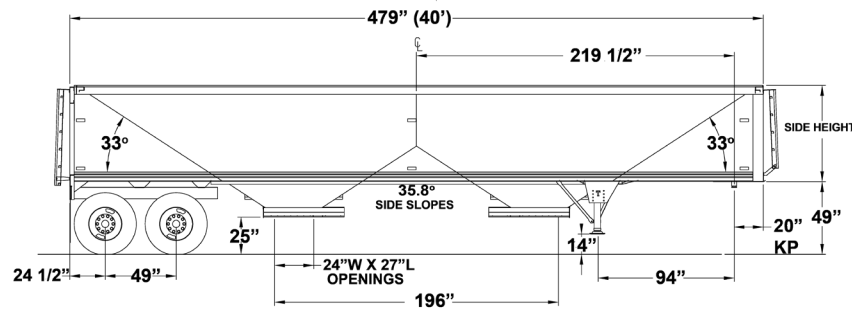

40' SUPER HOPPER

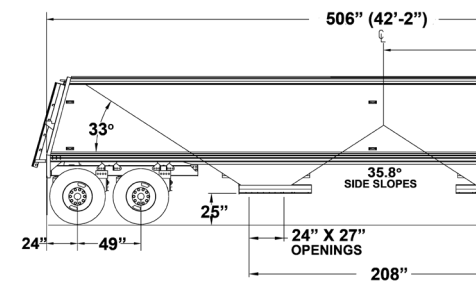

42' 2" SUPER HOPPER SL

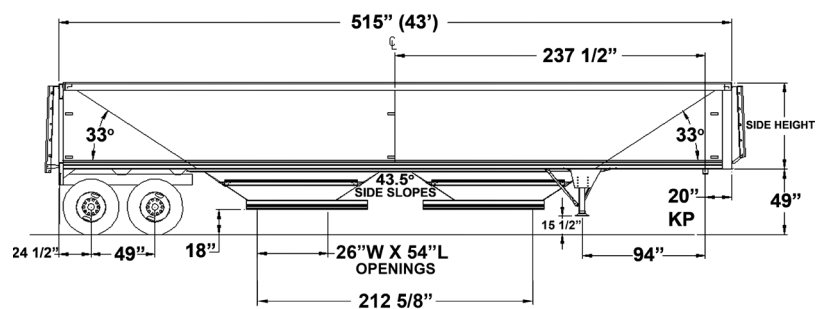
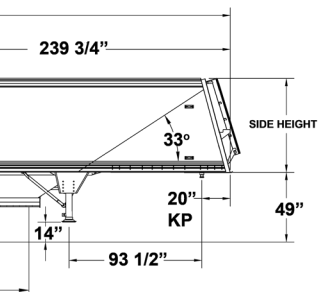

43' SUPER CUBE

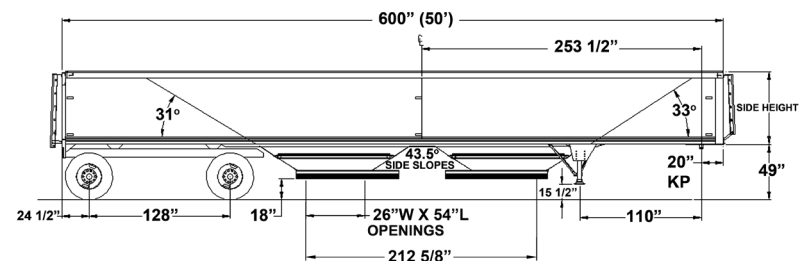

50' SPREAD-AXLE SUPER HOPPER

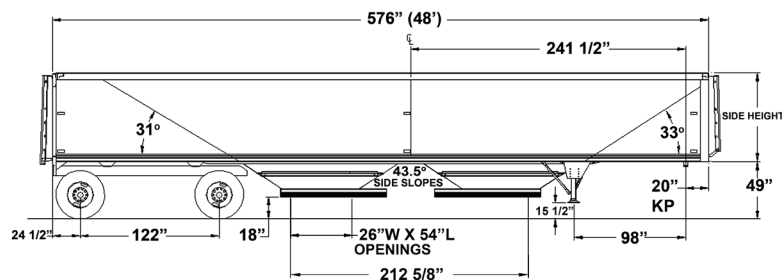
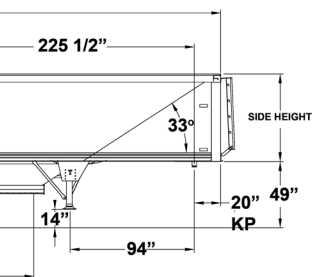

48' SPREAD-AXLE SUPER HOPPER

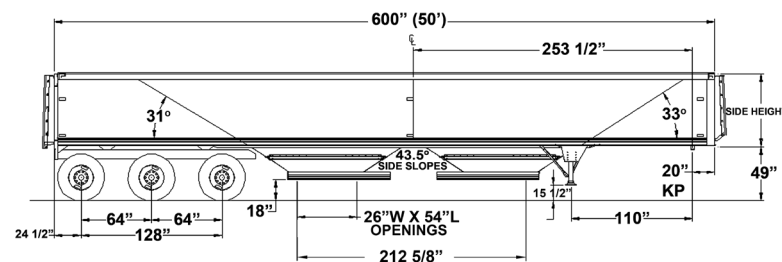

50' TRI-AXLE SUPER HOPPER

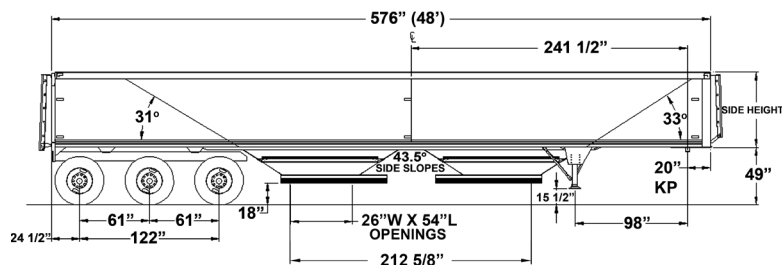
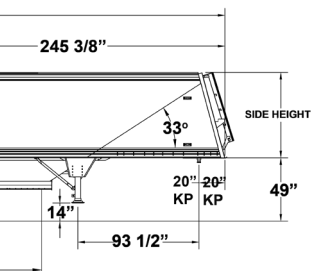

48' TRI-AXLE SUPER HOPPER

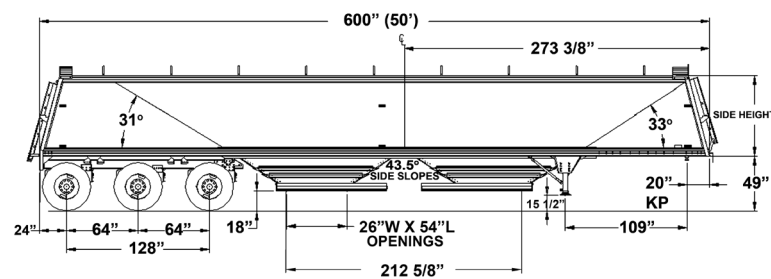

50' SUPER HOPPER SL

Standard Specifications

Application

Recommended for transportation of agricultural and industrial bulk commodities

Tires

Eight (8) 11R24.5 radials

Axles

2,500 lbs. beam capacity, 5 3/4" diameter, 71-1/2" or 77-1/2" track, 28-spline camshafts and "Q+" lining. Axles have Cam-Master "Q-style" quick-change brakes

Oil Seals

Wheel seals with hubcaps

Brakes

16-1/2" x 7" complying with FMVSS 121

Anti-Lock System

4 sensor, 2 modulator with constant power supplied by center auxiliary pin. Exceeds the minimum requirements of FMVSS 121, S5.5

Suspension

Air Ride Suspension, 17" ride height with 23,000 lbs. rating. Cast suspension beams

Support Legs

Square Legs, with roadside removable crank, low profile 10" square cushion foot shoe. 50,000 lbs. lift capacity. Located from king pin: 77" on 22'; 88 5/8" on 28'6"; 94" on 33'5", 36', 38', 40', 42'2", 43'; 98" on 48'; 110" on 50'

Wheel Flaps

Black heavy duty rubber, 24"W x 30"L

King Pin Setting

20" - Single I-beam with 3/8" steel flanges, 1/4" steel full-width pickup plate

Front Corners

6" radius, mill finish aluminum; SL Model 3" x 4-1/2" rectangular tube, mill finish aluminum, 15 degree rearward slant assembly

Nose Panels

Smooth pre-painted white .063" aluminum

Side Lower Rails

Aluminum 7-11/16" high extrusion

Side Posts

Aluminum extrusion 1-3/4" Z posts on 12" centers

Side Panels

Pre-painted white .048" and .063" in coupler area aluminum corrugated on 4" centers

Side Top Rails

Aluminum 5-5/8" x 6-1/4" extrusion

Interior Lining Sidewalls

.048" one piece aluminum

Divider Panel

.080" Aluminum

Metal Coating

Black protective coating on all steel parts

Tarp

ThunderArmor 18oz. roll tarp. Three (3) molded black plastic sidewall protectors

Tarp Opener

Thunder 6000^{XR} electric tarp opener system with One-TouchTM control and rf remote

Tarp Bows

9" rise galvanized steel arch type; Four (4) on 22'; Six (6) on 28'6", 33'5"; Seven (7) on 36', 38', 40'; Eight (8) on 42'2", 43'; Nine (9) on 48', 50'

Rear Frame

Corrugated pre-painted white .048" aluminum panels and extruded posts; SL Model - Corrugated pre-painted white .048" aluminum and 3" x 4-1/2" rectangular tube, mill finish aluminum 15 degree rearward slant assembly

End Slope

.080" aluminum supported 'Z' shaped members; 33 degree slope angle; *SL Models - 33 degree front and rear slope angle. 31 degree rear slope on tri-axle models*

Twin Hopper Assembly

22', 28'6", 33'5", 36', 38', 40', 42'2" - 96"W or 102"W on select models - Two piece .125" aluminum formed tubs with 35.8 degree side slopes and 33 degree end slopes, ag tub design
43" - 96"W or 102"W / 48', 50' - 96"W or 102"W;
two piece .125" aluminum formed tubs with 43.5 degree side slopes and 33 degree end slopes, split tub design

Traps

Trap plates are 1/4" aluminum with steel stiffeners supported by double sealed steel ball bearings
22' - 24"W x 36"L;
Hopper Clearance 25"
28'6", 33'5" - 24"W x 22"L;
Hopper Clearance 25"
36', 38', 40', 42'2" - 24"W x 27"L;
Hopper Clearance 25"
43', 48', 50' - 26"W x 54"L;
Hopper Clearance 17"
102"W trailers add 6" to trap width

Trap Operators

Each trap is opened and closed by a manually operated 1" diameter shaft connected through a u-joint to the double rack and pinion gears using a removable crank. There are trap locks at each crankshaft. The double rack and pinion gears drive at both sides of each trap plate

Access System

Aluminum ladders are mounted on both the front and the rear, with a flip down step mounted to the base of the rear ladder. Grab handle mounted above the rear ladder

Electrical System

Complies with FMVS 108 with connector 7" offset to roadside on nose. All weather-pack automotive style connections are sealed to prevent water intrusion and corrosion.

Side & Nose Markers

Clearance & ID Lamps

Side Lamps - (Bullet Style) 3 amber LED, 2 red LED, and 1 amber mid-turn/marker lamp in 2 rows of 3 lamps per side.
Nose Lamps - (Bullet Style) 2 high-mounted amber LED clearance lamps
Rear Lamps - (Bullet Style) 3 high-mounted red LED ID lamps and 2 high-mounted red LED clearance lamps on the rear frame header

Rear Tail Lamps

(6) 4" diameter, 7-diode red LED lamps, grommet mounted - two red turn signals and four red stop/tail lamps

Conspicuity

Red and white reflective tape mounted in line with bottom row of side marker lamps and full width across rear of trailer. White reflective tape mounted on top corners of rear frame

TimpTE reserves the right to change design or specifications without notice. Information contained herein is general in nature and is not intended for specific applications purposes.



Since 1884

1827 Industrial Drive / David City, NE 68632 / (402) 367-3056 / timpTE.com / sales@timpTE.com

TimpTE.COM

MADE IN AMERICA

4/19

